

Priced bill of quantities

Structural Budget (Detached Single-Family House)

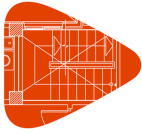

Project: Structural Budget (Detached Single-Family House)
 Location: Rawang (Selangor)
 Developer: CYPE

Date: 02/05/2024

Code	Description	Ut	Quantity	Rate (MYR)	Amount (MYR)
A	Work below lowest floor finish				
A0	Site preparation				
A0020	Clearing the undergrowth, bushes and similar land by pulling out their roots.	m ²	1.202	0,00	0,00
AE	Excavation and Earthwork				
AEC	Excavating trenches to receive foundations, starting from reduced level; including backfill with approved excavated material, compaction in layers and disposal of surplus excavated material where directed within the site:				
AEC010	To receive ground beams...	m ³	1	0,00	0,00
AEC070	Continuous footing for walls starting at platform level, maximum depth not exceeding 1.00m.	m ³	20	0,00	0,00
AEC090	Foundation slab starting at platform level, maximum depth not exceeding 0.50m.	m ³	11	0,00	0,00
AEE	Excavating for pile caps and trenches for ground beams between piles.				
AEE010	To receive pile caps starting at ground level, maximum depth not exceeding 3.00m	m ³	13	0,00	0,00
AEH	Excavating pits to receive bases of stanchions, columns , isolated piers and the like starting from reduced level including backfilling with approved excavated material, compaction in layers and disposal of surplus excavated material where directed within the site:				
AEH010	To receive footing bases not exceeding 0.25 m deep.	m ³	5	0,00	0,00
AEH060	To receive footing bases starting at formation level of 95.50m, having both plan dimensions less than 1.25m, maximum depth not exceeding 1.00m.	m ³	9	0,00	0,00
AEQ	Disposal and transportation of excavated material.				
AEQ010	Transport of earth by truck from the excavation of any type of soil to a specific landfill site, construction and demolition waste treatment facility outside the construction site or waste recovery or disposal centre, located at a maximum distance of 10 km.	m ³	34	0,00	0,00
AET	Blinding				
AET040	Plain in situ concrete (grade 15) in blinding bed, (not exceeding 100mm thick)	m ²	60	0,00	0,00
AF	Foundations / Sub-structure				
AFC	In situ Concrete				
AFCP	Plain concrete; (Grade 15) in:				
AFCP050	Foundation in trenches , poured against faces of excavation , not exceeding 100 - 150mm thick	m ³	20	0,00	0,00
AFCQ	Reinforced concrete (Grade 25) in:				
AFCQ005	Isolated foundation bases to column and piers, with top surface laid to horizontal; in;	m ³	14	0,00	0,00

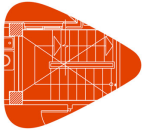

Project: Structural Budget (Detached Single-Family House)
 Location: Rawang (Selangor)
 Developer: CYPE

Date: 02/05/2024

Code	Description	Ut	Quantity	Rate (MYR)	Amount (MYR)
AFCQ050	Bed more than 300 mm thick to receive a further finish to be applied while the base is in an unset condition.	m ³	11	0,00	0,00
AFCR	Reinforced concrete (Grade 35) in:				
AFCR020	Ground beams.	m ³	1	0,00	0,00
AFCR040	Pile caps.	m ³	13	0,00	0,00
AFF	Formwork in:				
AFF070	Assembly and subsequent disassembly of recoverable formwork system formed by metal panels, for foundation and beds whose formwork faces exceed 1.00 m in height. Including elements of support, fixing and bends necessary for its stability and liquid form release agent, to avoid the adherence of the concrete to the formwork.	m ²	63	0,00	0,00
AFF100	Assembly and subsequent disassembly of recoverable formwork system formed by metal panels, for foundation and beds whose formwork faces are between 500 mm - 1.00 m high. Including elements of support, fixing and bends necessary for its stability and liquid form release agent, to avoid the adherence of the concrete to the formwork.	m	33	0,00	0,00
AFF140	Assembly and subsequent disassembly of recoverable formwork system formed by metal panels, for raft foundations whose formwork faces are between 500 mm - 1.00 m high. Including elements of support, fixing and bends necessary for its stability and liquid form release agent, to avoid the adherence of the concrete to the formwork.	m	10	0,00	0,00
AFF160	Formwork to kickers for walls. With both sides of the kicker formwork suspended.	m	8	0,00	0,00
B	Frame				
BC	In situ Concrete				
BCC	Reinforced concrete (Grade 35) in:				
BCCB	Beam				
BCCB005	Reinforced concrete beam.	m ³	31	0,00	0,00
BCE	Reinforced concrete (Grade 50) in:				
BCEC	Column				
BCEC005	Reinforced concrete column.	m ³	23	0,00	0,00
BE	Formwork in:				
BEA	Beam				
BEA160	Formwork of sides and soffit of dropped beam horizontal.	m ²	20	0,00	0,00
BEC	Column				
BEC060	Formwork for rectangular or square reinforced concrete isolated column.	m ²	149	0,00	0,00
C	Concrete walls				
CE	Formwork in:				
CE060	Double faced formwork for vertical concrete walls. Not exceeding 3.50m high.	m ²	6	0,00	0,00

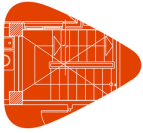

Project: Structural Budget (Detached Single-Family House)
 Location: Rawang (Selangor)
 Developer: CYPE

Date: 02/05/2024

Code	Description	Ut	Quantity	Rate (MYR)	Amount (MYR)
CE150	Formwork to ends to walls of reinforced concrete. Between 250 mm and 500 mm wide.	m	2	0,00	0,00
D	Upper Floor				
DC	In situ Concrete				
DCC	Reinforced concrete (Grade 25) in:				
DCC070	Solid slab, between 150 -300 mm thick.	m ³	36	0,00	0,00
DCC080	Solid slab, more than 300 mm thick.	m ³	8	0,00	0,00
DE	Formwork in:				
DE090	Formwork for the soffit of a horizontal solid floor slab. Not exceeding 200 mm thickness.	m ²	135	0,00	0,00
DE100	Formwork for the soffit of a horizontal solid floor slab. Between 200 mm and 300 mm thickness.	m ²	26	0,00	0,00
DE110	Formwork for the soffit of a horizontal solid floor slab. Between 300 mm and 400 mm thickness.	m ²	27	0,00	0,00
DE220	Formwork for flat beam soffit in horizontal solid floor slab. Between 200 mm and 300 mm thickness.	m ²	43	0,00	0,00
DE340	Formwork to soffit of drop panel in horizontal solid floor slab. Between 200 mm and 300 mm thickness.	m ²	114	0,00	0,00
DK	Hollow-block suspended slabs construction (lost cassette)				
DKC	In situ Concrete				
DKCC	Reinforced concrete (Grade 25) in:				
DKCC030	Waffle slab with lost cassette, between 150 -300 mm thick.	m ²	35	0,00	0,00
DKE	Formwork in:				
DKE010	Formwork of soffits of hollow-block floor slab horizontal.	m ²	392	0,00	0,00
DKE040	Formwork for flat beam soffit in horizontal hollow-block floor slab horizontal.	m ²	47	0,00	0,00
DKE070	Formwork to soffit of drop panel in horizontal hollow-block slab.	m ²	114	0,00	0,00
DQ	Composite construction				
DQC	In situ Concrete				
DQCC	Reinforced concrete (Grade 25) in:				
DQCC0170	Composite slab type "Composite deck"b. Between 150 -300 mm thick slab.	m ³	9	0,00	0,00
DQCC090	Precast concrete hollow core plate floor slab. Between 150 -300 mm thick slab.	m ³	7	0,00	0,00
DQK	Precast pieces and blocks				
DQK050_2e	Prestressed precast concrete hollow core slab. 0.25 m edge.	m ²	133	0,00	0,00
DQM	Elements for composite slab with metal sheet				

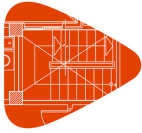

Project: Structural Budget (Detached Single-Family House)
 Location: Rawang (Selangor)
 Developer: CYPE

Date: 02/05/2024

Code	Description	Ut	Quantity	Rate (MYR)	Amount (MYR)
DQM010	"Galvanized profiled steel sheet with galvanized steel disc head connectors, for fixing to a steel structure by welding to the composite sheet. Including angle pieces for perimeter and cantilever finishes, and screws for fixing the sheets.	m ²	51	0,00	0,00
E	Staircases				
EE	Formwork in:				
EE115	Formwork for soffits of slabs staircases of any thickness with an inclination exceeding 15° from the horizontal.	m ²	18	0,00	0,00
EE260	Formwork of edges of slabs in staircases. Between 250 mm and 500 mm deep.	m	24	0,00	0,00
H	Walls (Façades and partitions)				
HF	Internal wall				
HFC	Brickwork				
HFCF	Clay brickwork in cement and sand (1:6) mortar with and approved plasticiser as specified:				
HFCF020_5e	Brickwall partitioning of 0.2 m thick.	m ²	123	0,00	0,00
HFCF020_5f	Brickwall partitioning of 0.1 m thick.	m ²	205	0,00	0,00
HH	Brick facework				
HHC	Facework				
HHC240_4e	Window sill of 1.75 m long made of perforated, water-repellent, salmon-colored, smooth-finished, ceramic facing brick, 215x102.5x65 mm, embedded in the jambs; bedded in 1:5 cement-sand mortar and jointed between pieces and at the junctions with the walls with low water absorption cement mortar.	m	2	0,00	0,00
HHC240_4f	Window sill of 1.5 m long made of perforated, water-repellent, salmon-colored, smooth-finished, ceramic facing brick, 215x102.5x65 mm, embedded in the jambs; bedded in 1:5 cement-sand mortar and jointed between pieces and at the junctions with the walls with low water absorption cement mortar.	m	2	0,00	0,00
HHC240_50	Window sill of 1 m long made of perforated, water-repellent, salmon-colored, smooth-finished, ceramic facing brick, 215x102.5x65 mm, embedded in the jambs; bedded in 1:5 cement-sand mortar and jointed between pieces and at the junctions with the walls with low water absorption cement mortar.	m	1	0,00	0,00
HHC240_51	Window sill of 1.2 m long made of perforated, water-repellent, salmon-colored, smooth-finished, ceramic facing brick, 215x102.5x65 mm, embedded in the jambs; bedded in 1:5 cement-sand mortar and jointed between pieces and at the junctions with the walls with low water absorption cement mortar.	m	4	0,00	0,00
HHC240_52	Window sill of 5.2 m long made of perforated, water-repellent, salmon-colored, smooth-finished, ceramic facing brick, 215x102.5x65 mm, embedded in the jambs; bedded in 1:5 cement-sand mortar and jointed between pieces and at the junctions with the walls with low water absorption cement mortar.	m	16	0,00	0,00

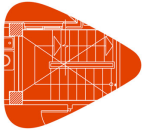

Project: Structural Budget (Detached Single-Family House)

Location: Rawang (Selangor)

Developer: CYPE

Date: 02/05/2024

Code	Description	Ut	Quantity	Rate (MYR)	Amount (MYR)
HHC240_53	Window sill of 0.9 m long made of perforated, water-repellent, salmon-colored, smooth-finished, ceramic facing brick, 215x102.5x65 mm, embedded in the jambs; bedded in 1:5 cement-sand mortar and jointed between pieces and at the junctions with the walls with low water absorption cement mortar.	m	1	0,00	0,00
HHC240_54	Window sill of 0.35 m long made of perforated, water-repellent, salmon-colored, smooth-finished, ceramic facing brick, 215x102.5x65 mm, embedded in the jambs; bedded in 1:5 cement-sand mortar and jointed between pieces and at the junctions with the walls with low water absorption cement mortar.	m	1	0,00	0,00
HHC240_55	Window sill of 0.5 m long made of perforated, water-repellent, salmon-colored, smooth-finished, ceramic facing brick, 215x102.5x65 mm, embedded in the jambs; bedded in 1:5 cement-sand mortar and jointed between pieces and at the junctions with the walls with low water absorption cement mortar.	m	1	0,00	0,00
HHC240_56	Window sill of 1.1 m long made of perforated, water-repellent, salmon-colored, smooth-finished, ceramic facing brick, 215x102.5x65 mm, embedded in the jambs; bedded in 1:5 cement-sand mortar and jointed between pieces and at the junctions with the walls with low water absorption cement mortar.	m	1	0,00	0,00
HHC240_57	Window sill of 0.4 m long made of perforated, water-repellent, salmon-colored, smooth-finished, ceramic facing brick, 215x102.5x65 mm, embedded in the jambs; bedded in 1:5 cement-sand mortar and jointed between pieces and at the junctions with the walls with low water absorption cement mortar.	m	0	0,00	0,00
HHC240_58	Window sill of 1.8 m long made of perforated, water-repellent, salmon-colored, smooth-finished, ceramic facing brick, 215x102.5x65 mm, embedded in the jambs; bedded in 1:5 cement-sand mortar and jointed between pieces and at the junctions with the walls with low water absorption cement mortar.	m	7	0,00	0,00
HHC240_59	Window sill of 2.4 m long made of perforated, water-repellent, salmon-colored, smooth-finished, ceramic facing brick, 215x102.5x65 mm, embedded in the jambs; bedded in 1:5 cement-sand mortar and jointed between pieces and at the junctions with the walls with low water absorption cement mortar.	m	2	0,00	0,00
HHC240_5a	Window sill of 4.85 m long made of perforated, water-repellent, salmon-colored, smooth-finished, ceramic facing brick, 215x102.5x65 mm, embedded in the jambs; bedded in 1:5 cement-sand mortar and jointed between pieces and at the junctions with the walls with low water absorption cement mortar.	m	5	0,00	0,00
HHC240_5b	Window sill of 3.5 m long made of perforated, water-repellent, salmon-colored, smooth-finished, ceramic facing brick, 215x102.5x65 mm, embedded in the jambs; bedded in 1:5 cement-sand mortar and jointed between pieces and at the junctions with the walls with low water absorption cement mortar.	m	4	0,00	0,00
HHC240_5c	Window sill of 2 m long made of perforated, water-repellent, salmon-colored, smooth-finished, ceramic facing brick, 215x102.5x65 mm, embedded in the jambs; bedded in 1:5 cement-sand mortar and jointed between pieces and at the junctions with the walls with low water absorption cement mortar.	m	2	0,00	0,00

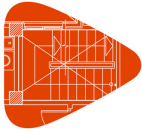

Project: Structural Budget (Detached Single-Family House)

Location: Rawang (Selangor)

Developer: CYPE

Date: 02/05/2024

Code	Description	Ut	Quantity	Rate (MYR)	Amount (MYR)
HHC240_5d	Window sill of 2.65 m long made of perforated, water-repellent, salmon-colored, smooth-finished, ceramic facing brick, 215x102.5x65 mm, embedded in the jambs; bedded in 1:5 cement-sand mortar and jointed between pieces and at the junctions with the walls with low water absorption cement mortar.	m	3	0,00	0,00
HHC250_4a	Door threshold of 0.85 m long made of perforated, water-repellent, salmon-colored, smooth-finished, ceramic facing brick, 215x102.5x65 mm, embedded in the jambs; bedded in 1:5 cement-sand mortar and jointed between pieces and at the junctions with the walls with low water absorption cement mortar.	m	1	0,00	0,00
HHC250_4b	Door threshold of 5.8 m long made of perforated, water-repellent, salmon-colored, smooth-finished, ceramic facing brick, 215x102.5x65 mm, embedded in the jambs; bedded in 1:5 cement-sand mortar and jointed between pieces and at the junctions with the walls with low water absorption cement mortar.	m	6	0,00	0,00
HHC250_4c	Door threshold of 1 m long made of perforated, water-repellent, salmon-colored, smooth-finished, ceramic facing brick, 215x102.5x65 mm, embedded in the jambs; bedded in 1:5 cement-sand mortar and jointed between pieces and at the junctions with the walls with low water absorption cement mortar.	m	1	0,00	0,00
HHC250_4d	Door threshold of 0.7 m long made of perforated, water-repellent, salmon-colored, smooth-finished, ceramic facing brick, 215x102.5x65 mm, embedded in the jambs; bedded in 1:5 cement-sand mortar and jointed between pieces and at the junctions with the walls with low water absorption cement mortar.	m	1	0,00	0,00