

## INDEX

1.- OU - LEFT.....	2
1.1.- Project Compliance.....	2
1.2.- Equipment List.....	2
1.3.- Details.....	3
1.4.- Schema.....	4
2.- OU - RIGHT.....	5
2.1.- Project Compliance.....	5
2.2.- Equipment List.....	5
2.3.- Details.....	6
2.4.- Schema.....	7

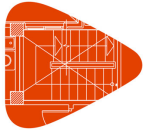

Project:  
Location:  
Developer:

## 1.- OU - LEFT

### 1.1.- Project Compliance

Checks	Design	Specification	Meets the requirements
Permitted capacity ratio	94 %	80 % - 130 %	✓
Connected indoor units	3	2 - 8	✓
Total pipe length	19.81 m	180.00 m	✓
Real pipe length to the furthest unit	13.97 m	100.00 m	✓
Equivalent pipe length to the furthest unit	16.76 m	125.00 m	✓
Main piping equivalent length	6.06 m	65.00 m	✓
Equivalent pipe length to the furthest unit, from the first branch	10.71 m	35.00 m	✓
Real connection pipe length to the indoor unit	5.92 m	15.00 m	✓
Difference in height between indoor and outdoor units	3.00 m	30.00 m	✓
Difference in height between indoor units	0.00 m	15.00 m	✓

### 1.2.- Equipment List

#### Outdoor units

Equipment	Overview	Quantity
MCY-MHP0404HS-E	Outdoor unit, heat pump (2 pipe)	1

#### Indoor units

Equipment	Overview	Quantity
MML-AP0124NH-E	1.3HP Indoor unit VRF, floor bi-flow	3

#### Y joints

Equipment	Overview	Quantity
RBM-BY55E	Y branch	2

#### Tube length

Pipe Diameter	Gas side (m)	Discharge side (m)	Liquid side (m)	Total length (m)
Ø6.4 mm (1/4")	0	0	11.77	11.77
Ø9.5 mm (3/8")	11.77	0	8.05	19.81
Ø15.9 mm (5/8")	8.05	0	0	8.05

#### Additional refrigerant load

Refrigerant (R410A)	Quantity (kg)
Additional refrigerant	0.737
Standard manufacturer's refrigerant load	6.400

#### Remote controls



Project:  
Location:  
Developer:

Equipment	Overview	Quantity
RBC-AMT32E	Remote control with cable - Standard	3

### 1.3.- Details

#### Outdoor unit

Equipment	Heating (kW)		Cooling (kW)		Diversity (%)
	Nominal	Corrected	Nominal	Corrected	System
MCY-MHP0404HS-E	12.5	11.0	12.1	11.6	93.8

#### Outdoor Design Temperature

Mode	Overview	Temperature (°C)
Cooling	Dry bulb temperature	36.1
Heating	Wet bulb temperature	2.6

#### Indoor units

Equipment	Unit Name & Space	Capacity Code	Mode	Capacity (Total/Sensible) (kW)		
				Nominal	Corrected	Required
MML-AP0124NH-E	IU - Left 1	1.3HP	Cooling	4.0/3.6	3.4/2.6	3.4/2.1
			Heating	2.6	4.0	2.0
MML-AP0124NH-E	IU - Left 2	1.3HP	Cooling	4.0/3.6	3.4/2.5	3.4/2.1
			Heating	2.6	3.9	2.0
MML-AP0124NH-E	IU - Left 3	1.3HP	Cooling	4.0/3.6	3.4/2.5	3.4/2.1
			Heating	2.6	3.9	2.0

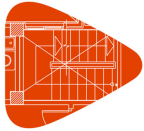

Project:  
Location:  
Developer:

## 1.4.- Schema

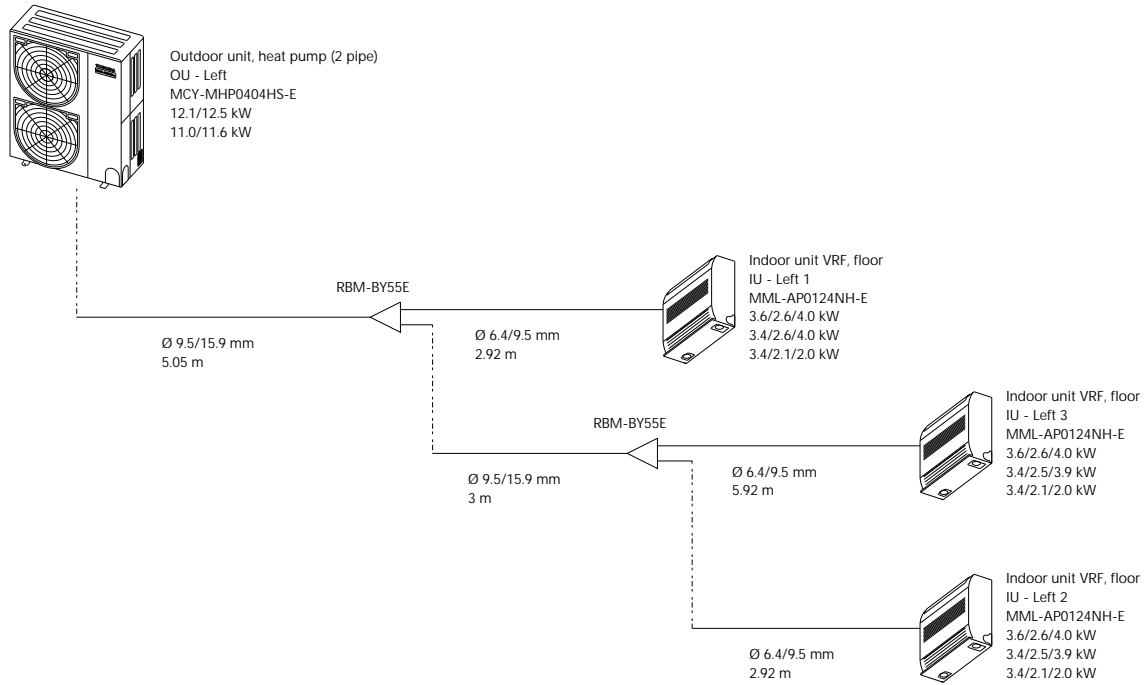

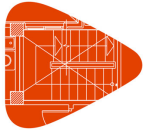

Project:  
Location:  
Developer:

## 2.- OU - RIGHT

### 2.1.- Project Compliance

Checks	Design	Specification	Meets the requirements
Permitted capacity ratio	113 %	80 % - 130 %	✓
Connected indoor units	4	2 - 13	✓
Total pipe length	14.15 m	180.00 m	✓
Real pipe length to the furthest unit	12.40 m	100.00 m	✓
Equivalent pipe length to the furthest unit	14.88 m	125.00 m	✓
Main piping equivalent length	3.39 m	65.00 m	✓
Equivalent pipe length to the furthest unit, from the first branch	11.50 m	35.00 m	✓
Real connection pipe length to the indoor unit	3.58 m	15.00 m	✓
Difference in height between indoor and outdoor units	0.30 m	30.00 m	✓
Difference in height between indoor units	0.00 m	15.00 m	✓

### 2.2.- Equipment List

#### Outdoor units

Equipment	Overview	Quantity
MCY-MHP0604HS-E	Outdoor unit, heat pump (2 pipe)	1

#### Indoor units

Equipment	Overview	Quantity
MMC-AP0158HP-E	1.7HP Indoor unit VRF, ceiling	4

#### Y joints

Equipment	Overview	Quantity
RBM-BY55E	Y branch	3

#### Tube length

Pipe Diameter	Gas side (m)	Discharge side (m)	Liquid side (m)	Total length (m)
Ø6.4 mm (1/4")	0	0	5.32	5.32
Ø9.5 mm (3/8")	0	0	8.82	8.82
Ø12.7 mm (1/2")	5.32	0	0	5.32
Ø15.9 mm (5/8")	6	0	0	6
Ø19.1 mm (3/4")	2.82	0	0	2.82

#### Additional refrigerant load

Refrigerant (R410A)	Quantity (kg)
Additional refrigerant	1.418
Standard manufacturer's refrigerant load	6.400



Project:  
Location:  
Developer:

#### Remote controls

Equipment	Overview	Quantity
RBC-AMT32E	Remote control with cable - Standard	4

## 2.3.- Details

### Outdoor unit

Equipment	Heating (kW)		Cooling (kW)		Diversity (%)
	Nominal	Corrected	Nominal	Corrected	System
MCY-MHP0604HS-E	18.0	14.5	15.5	17.1	113.3

### Outdoor Design Temperature

Mode	Overview	Temperature (°C)
Cooling	Dry bulb temperature	36.1
Heating	Wet bulb temperature	2.6

### Indoor units

Equipment	Unit Name & Space	Capacity Code	Mode	Capacity (Total/Sensible) (kW)		
				Nominal	Corrected	Required
MMC-AP0158HP-E	IU - Right 1	1.7HP	Cooling	5.0/4.5	4.3/3.3	3.4/2.1
			Heating	3.4	5.0	2.0
MMC-AP0158HP-E	IU - Right 2	1.7HP	Cooling	5.0/4.5	4.3/3.3	3.4/2.1
			Heating	3.4	4.9	2.0
MMC-AP0158HP-E	IU - Right 3	1.7HP	Cooling	5.0/4.5	4.2/3.3	3.4/2.1
			Heating	3.4	4.9	2.0
MMC-AP0158HP-E	IU - Right 4	1.7HP	Cooling	5.0/4.5	4.2/3.2	3.4/2.1
			Heating	3.4	4.9	2.0



Project:  
Location:  
Developer:

## 2.4.- Schema

